

# 317 *On Rice Park* EVENT CENTER

# Wedding 2019 PRICE SHEET

## Wedding Reception Only

|                      |        |
|----------------------|--------|
| All-Day Facility Fee |        |
| Riverside -          | \$1000 |
| Riverside +1 -       | \$1300 |
| Riverside +2 -       | \$1500 |

Plus \$5000 Food & Beverage Minimum  
(before taxes and service fees)

## Wedding Ceremony Only

|                     |        |
|---------------------|--------|
| 4-Hour Facility Fee |        |
| Riverside -         | \$5000 |
| Riverside +1 -      | \$5500 |
| Riverside +2 -      | \$6000 |

## Wedding Ceremony & Reception

|                      |        |
|----------------------|--------|
| All-Day Facility Fee |        |
| Riverside -          | \$1500 |
| Riverside +1 -       | \$1600 |
| Riverside +2 -       | \$1700 |

Plus \$5000 Food & Beverage Minimum  
(before taxes and service fees)

### Facility Fees include:

China/Glassware | In-house Black, White or Ivory Linen | Set-Up/Breakdown | Attendants

|                   |                           |
|-------------------|---------------------------|
| <b>Riverside</b>  | Seated: 168 Standing: 336 |
| <b>John's Bar</b> | Seated: 64 Standing: 128  |
| <b>Club Room</b>  | Seated: 60 Standing: 120  |

Prices do not include 21% service fee and state/alcohol taxes



*Levy*

*"the event rooms at 317 on Rice Park feature high ceilings, expansive windows and rich, detailed woodwork..."*

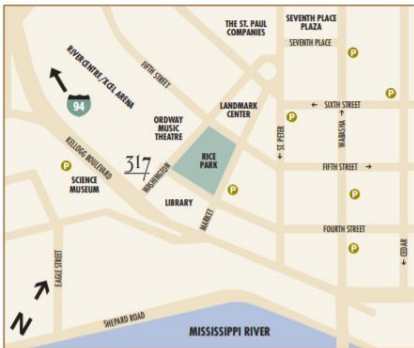
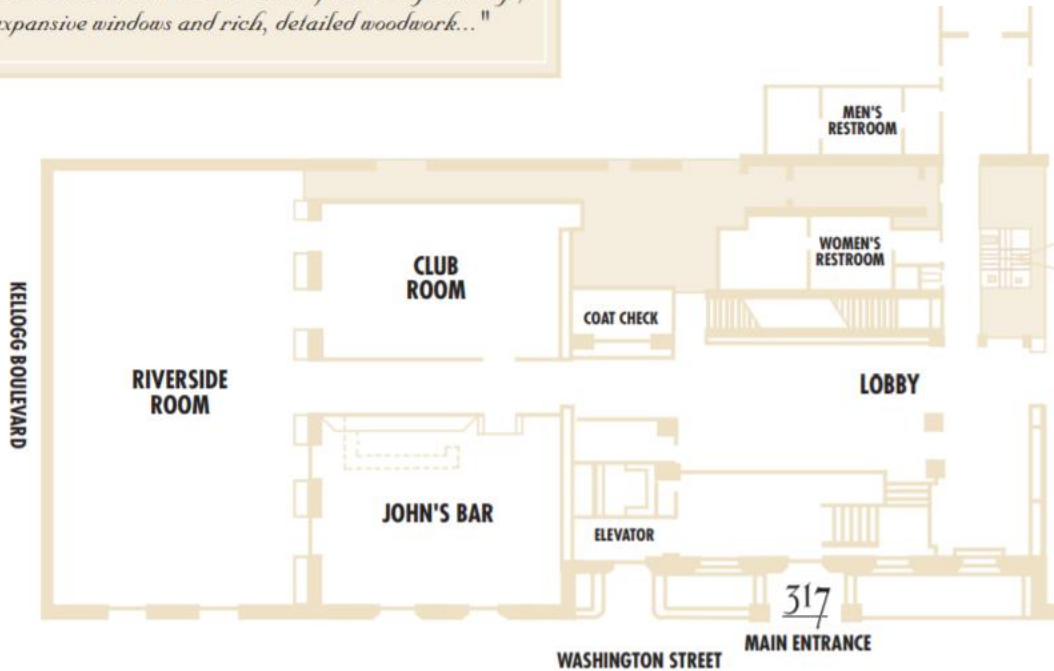

| ROOM       | DIMENSIONS                | CONFERENCE STYLE | CLASSROOM | THEATER | ROUNDS | RECEPTION |
|------------|---------------------------|------------------|-----------|---------|--------|-----------|
| CLUB ROOM  | 37' x 24'<br>888 sq. ft.  | 30               | 28        | 65      | 60     | 75        |
| JOHN'S BAR | 37' x 26'<br>882 sq. ft.  | NA               | NA        | 50      | 59     | 75        |
| RIVERSIDE  | 68' x 37'<br>2516 sq. ft. | 60               | 150       | 200     | 160    | 225       |

#### Dance Floor:

- \$500 (24x24)

#### Staging:

- \$200 (6) 8' x 8' sections – 16" high

#### Coat Check Attendant (by request)

- \$100 (4 hours) \$25/additional hour

#### Dessert Fee (if own dessert is brought in)

- \$2 per person

#### Dessert –Cut & Serve Fee:

- \$3 per person

#### Corkage Fee:

- \$25 Per Opened Bottle

#### Bartender Fee:

- \$150 each (staff 1 per 75 guests)

#### LED UPLIGHT(s):

- \$35 each